

21700148	<b>DATA SHEET</b>	
Valid from: 13.07.2022	<b>ETHERLINE® ACCESS U08M12</b>	

## Description

- Fast Ethernet Network-Switch (10/100BaseT(X)), unmanaged
- Ports: M12-D  
Suitable for harsh industrial environment (IP class IP67)
- PROFINET Conformance Class A



## General characteristics

Interfaces	<b>X1:</b> 8x M12-D: 10/100BaseT(X) Auto-Negotiation, Full- / Halfduplexmode and Auto-MDI/MDI-X <b>X2:</b> 1x M12-L (male, 5-pol) – voltage supply <b>X3:</b> 1x M12-A (female, 5-pol) – without function
Switch properties	<b>MAC table size:</b> 16 K <b>paket buffer size:</b> 256 Kbit <b>protocols:</b> LLDP & PTCP Delay-Traffic Blocking
Temperature range	ambient temp.: -25°C to +75°C (-13°F to 167°F) transport - and storage temp.: -40°C to +85°C (-40°F to 185°F)
relative humidity	95 % (non-condensing)
Pollution degree	2
Standard	IEEE 802.3i (10BaseT) IEEE 802.3u (100BaseTX) IEEE 802.3x (Flow control) IEEE 802.1Q (QoS)
Data switching type	Store and forward
MTBF (mean time between failures)	11.32 years @ MIL-HDBK-217F
Torque for IP degree of protection	0.8 Nm

## Variation

Article	Description	Amount of data-ports
21700148	ETHERLINE ACCESS U08M12	8

## Power requirements

Voltage Input	24 V DC (18-30V DC)
Power Consumption (max.)	2 W
Input current (max.) 24 V DC	80 mA

Creator: THLE3/PDP Released: IVSE1/PDP	Document: DB21700148EN Version: 00	Page 1 of 3
---	---------------------------------------	-------------

21700148	<b>DATA SHEET</b>	
Valid from: 13.07.2022	<b>ETHERLINE® ACCESS U08M12</b>	

**Physical properties**

IP class	IP67
Weight	0.41 kg
Installation	Screwing via hole pattern

**Technical drawing**

Dimensional drawing

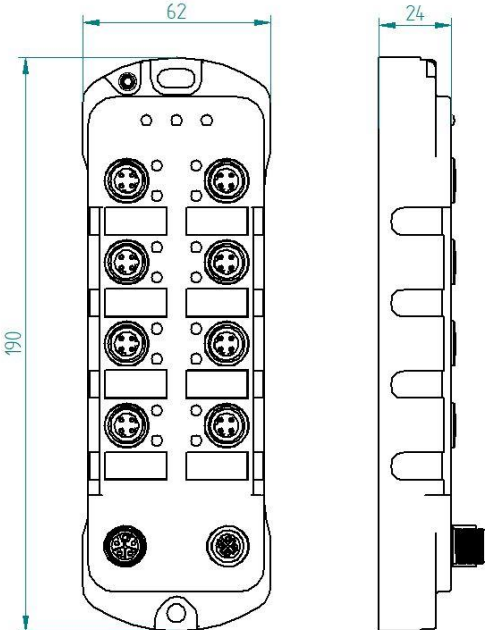

Hole pattern

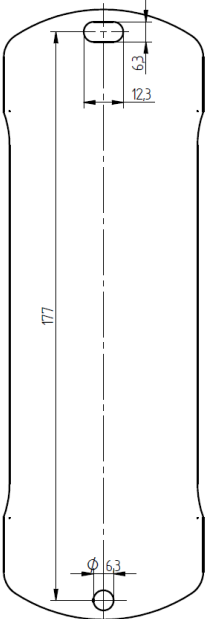

We reserve all rights according to DIN ISO 16016.  
 PD 0019/05\_04.18EN

21700148	<b>DATA SHEET</b>	
Valid from: 13.07.2022	<b>ETHERLINE® ACCESS U08M12</b>	

### Standards and approvals

EMC	DIN EN IEC 61000-6-2
	DIN EN IEC 61000-6-4
PROFINET	Conformance Class A
Approvals	CE

### Application range

Automation, industrial machinery and plant engineering

### Note

Photographs are not to scale and do not represent detailed images of the respective products.

Creator: THLE3/PDP Released: IVSE1/PDP	Document: DB21700148EN Version: 00	Page 3 of 3
---	---------------------------------------	-------------