

|                           |                            |   |
|---------------------------|----------------------------|---|
| 44423116                  | <b>DATA SHEET</b>          |  |
| Valid from:<br>30.03.2023 | <b>EPIC® M17 SIGNAL G4</b> |   |

### Description:

Device connector for front wall mounting  
 SPEEDCON-Lock, M17  
 Number of pins: 8 or 17  
 Contact type: male/female, Crimp connection  
 Sealing: O-Ring axial  
 Shielded: yes  
 Central mounting



### Product variations:

| Article number | Typ    | Pin-arrangement | PU |
|----------------|--------|-----------------|----|
| 44423118       | female | 8 Pin           | 5  |
| 44423116       | male   | 8 Pin           | 5  |
| 44423119       | female | 17 Pin          | 5  |
| 44423117       | male   | 17 Pin          | 5  |

### General characteristics:

|                                |  |
|--------------------------------|--|
| Connector type                 | Device connector/ Panel plug               |
| Number of pins                 | 8 / 17                                     |
| Connector lock                 | Speedcon                                   |
| Mounting type                  | Central mounting M18x0,75 with counter nut |
| Termination method             | Crimp termination                          |
| Upper temperature limit        | + 125 °C                                   |
| Lower temperature limit        | - 40 °C                                    |
| Contacts, base material        | CuZn (brass)                               |
| Contacts, surface              | Au (gold)                                  |
| Insert material                | PA   |
| Housing material               | Nickel plated zinc die-casting             |
| Sealing material               | FPM  |
| Protection class               | IP 67                                      |
| Pollution degree               | 3  |
| Overvoltage category           | III  |
| Cycles of mechanical operation | >100                                       |

|   |                                       |             |
|---|---------------------------------------|-------------|
| Creator: STKU3/PDP<br>Released: IVSE1/PDP | Document: DB44423116EN<br>Version: 03 | Page 1 of 4 |
|---|---------------------------------------|-------------|

|                           |                            |   |
|---------------------------|----------------------------|---|
| 44423116                  | <b>DATA SHEET</b>          |  |
| Valid from:<br>30.03.2023 | <b>EPIC® M17 SIGNAL G4</b> |   |

## Version 8 Pin

### Electrical characteristics:

|                           |  |
|---------------------------|--|
| Rated voltage             | 48V AC / 74V DC                            |
| Rated impulse voltage     | 1500 V                                     |
| Rated current (25°C)      | 3,6 A                                      |
| Contact diameter          | 1 mm                                       |
| Termination cross-section | 0,06 mm <sup>2</sup> – 1,0 mm <sup>2</sup> |

### Pin-arrangement:

Female

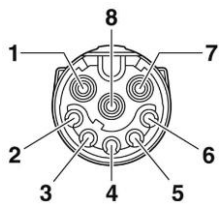

Male

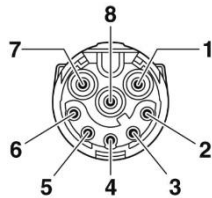

### Fitting female contacts (contacts must be ordered separately)



| Lapp Art. No. | Description   |
|---------------|---|
| 44423122:     | Crimp contact, drilled, contact diameter: 1 mm, termination cross-section: 0,06 mm <sup>2</sup> ...0,25 mm <sup>2</sup> |
| 44423123:     | Crimp contact, drilled, contact diameter: 1 mm, termination cross-section: 0,34 mm <sup>2</sup> ...0,5 mm <sup>2</sup>  |
| 44423124:     | Crimp contact, drilled, contact diameter: 1 mm, termination cross-section: 0,5 mm <sup>2</sup> ...1 mm <sup>2</sup>     |

### Fitting male contacts (contacts must be ordered separately)



| Lapp Art. No. | Description   |
|---------------|---|
| 44423130:     | Crimp contact, drilled, contact diameter: 1 mm, termination cross-section: 0,06 mm <sup>2</sup> ...0,25 mm <sup>2</sup> |
| 44423131:     | Crimp contact, drilled, contact diameter: 1 mm, termination cross-section: 0,34 mm <sup>2</sup> ...0,5 mm <sup>2</sup>  |
| 44423132:     | Crimp contact, drilled, contact diameter: 1 mm, termination cross-section: 0,5 mm <sup>2</sup> ...1 mm <sup>2</sup>     |

|   |                                       |             |
|---|---------------------------------------|-------------|
| Creator: STKU3/PDP<br>Released: IVSE1/PDP | Document: DB44423116EN<br>Version: 03 | Page 2 of 4 |
|---|---------------------------------------|-------------|

|                           |                            |   |
|---------------------------|----------------------------|---|
| 44423116                  | <b>DATA SHEET</b>          |  |
| Valid from:<br>30.03.2023 | <b>EPIC® M17 SIGNAL G4</b> |   |

## Version 17 Pin

### Electrical characteristics:

|                           |  |
|---------------------------|--|
| Rated voltage             | 48V AC / 74V DC                            |
| Rated impulse voltage     | 1500 V                                     |
| Rated current (25°C)      | 3,6 A                                      |
| Contact diameter          | 0,6 mm                                     |
| Termination cross-section | 0,06 mm <sup>2</sup> – 0,5 mm <sup>2</sup> |

### Pin-arrangement:

#### Female

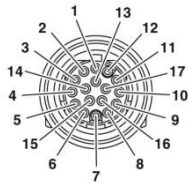

#### Male

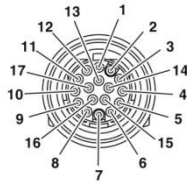

### Fitting female contacts (contacts must be ordered separately)



| Lapp Art. No. | Description   |
|---------------|---|
| 44423125:     | Crimp contact, drilled, contact diameter: 0,6 mm, termination cross-section: 0,06 mm <sup>2</sup> ...0,25 mm <sup>2</sup> |
| 44423126:     | Crimp contact, drilled, contact diameter: 0,6 mm, termination cross-section: 0,06 mm <sup>2</sup> ...0,34 mm <sup>2</sup> |
| 44423127:     | Crimp contact, drilled, contact diameter: 0,6 mm, termination cross-section: 0,34 mm <sup>2</sup> ...0,5 mm <sup>2</sup>  |

### Fitting male contacts (contacts must be ordered separately)



| Lapp Art. No. | Description   |
|---------------|---|
| 44423133:     | Crimp contact, drilled, contact diameter: 0,6 mm, termination cross-section: 0,06 mm <sup>2</sup> ...0,25 mm <sup>2</sup> |
| 44423134:     | Crimp contact, drilled, contact diameter: 0,6 mm, termination cross-section: 0,06 mm <sup>2</sup> ...0,34 mm <sup>2</sup> |
| 44423135:     | Crimp contact, drilled, contact diameter: 0,6 mm, termination cross-section: 0,34 mm <sup>2</sup> ...0,5 mm <sup>2</sup>  |

|   |                                       |             |
|---|---------------------------------------|-------------|
| Creator: STKU3/PDP<br>Released: IVSE1/PDP | Document: DB44423116EN<br>Version: 03 | Page 3 of 4 |
|---|---------------------------------------|-------------|

|                           |                     |   |
|---------------------------|---------------------|---|
| 44423116                  | <b>DATA SHEET</b>   |  |
| Valid from:<br>30.03.2023 | EPIC® M17 SIGNAL G4 |   |

**Drawings and dimensions of the connector:**

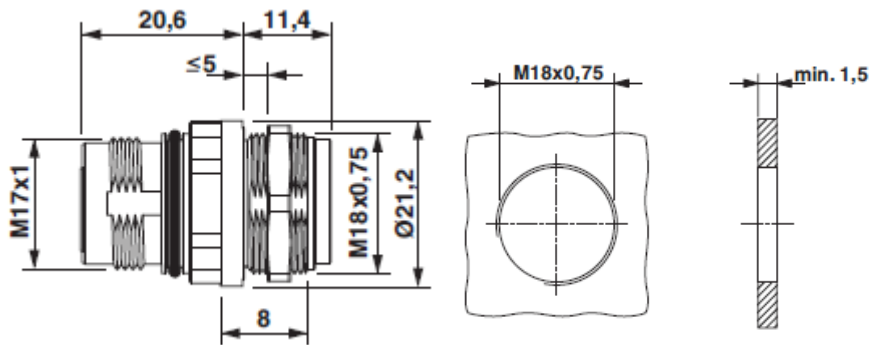

**Needed holes and breakthroughs at the housing:**

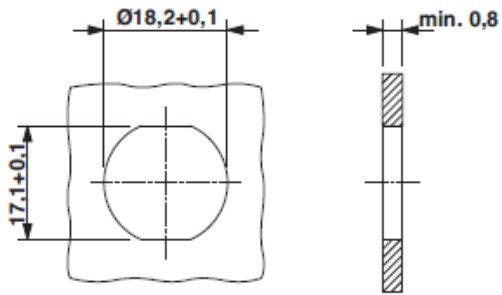

**Application range:**

Plant engineering; measurement and control technology; apparatus construction

**Remark:**

Photographs are not to scale and do not represent detailed images of the respective products.

|   |                                       |             |
|---|---------------------------------------|-------------|
| Creator: STKU3/PDP<br>Released: IVSE1/PDP | Document: DB44423116EN<br>Version: 03 | Page 4 of 4 |
|---|---------------------------------------|-------------|