

10625500	DATA SHEET	
Valid from: 29.08.2022	EPIC® H-A 48 AG	

Description

- The large, robust housing for three inserts of size 16.



General Characteristics

Series	H-A 48
Version	Panel mount base
Locking	Double lever
Protection (DIN EN 60529)	IP 65 (latched)
Temperature Range	-40°C to +100°C, short term up to +125°C

Materials / Surfaces

Housing	Aluminium alloy, powder-coated, grey
Locking	Steel, zinc-plated
Sealing	NBR

Standard

Safety Standard	IEC 61984
-----------------	-----------

Versions

Article number	Article description
10625500	EPIC® H-A 48 AG

Creator: BEGE1/PDP Released: IVSE1/PDP	Document: DB10625500EN Version: 00	Page 1 of 2
---	---------------------------------------	-------------

10625500	DATA SHEET	
Valid from: 29.08.2022	EPIC® H-A 48 AG	

Technical Drawings

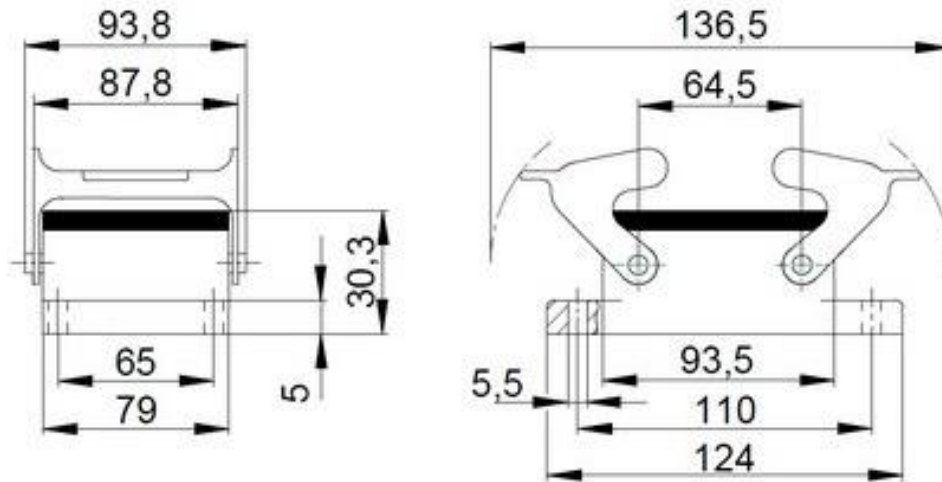

Industrial machinery and plant engineering



Mechanical resistance



Robust



Waterproof

Application range

Machine and equipment manufacturing, Control engineering

Remark

Photographs are not to scale and do not represent detailed images of the respective products.

Creator: BEGE1/PDP Released: IVSE1/PDP	Document: DB10625500EN Version: 00	Page 2 of 2
---	---------------------------------------	-------------